

**GROUND FLOOR
KEY PLAN**
SCALE 1:500

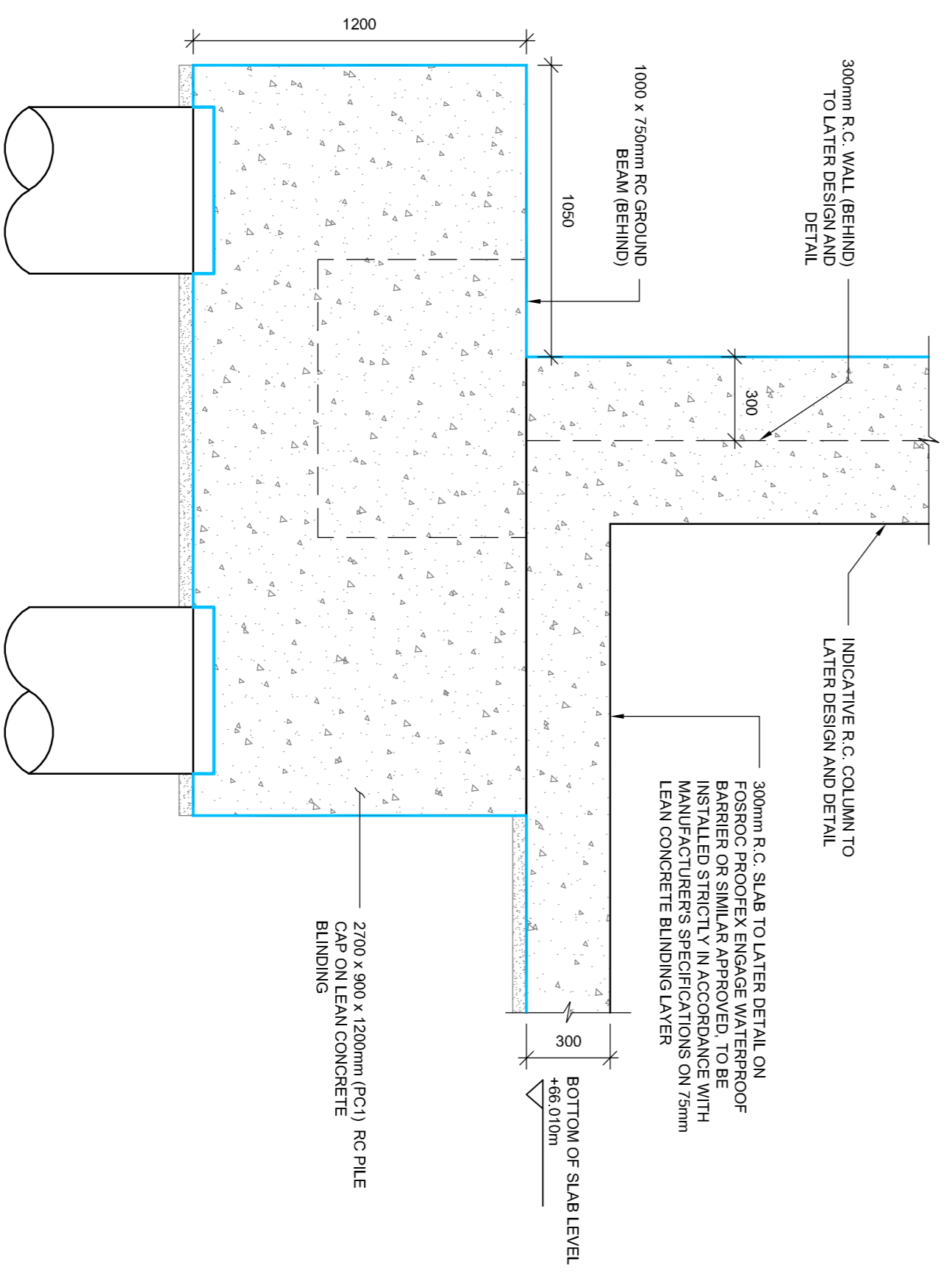

**SECTION 1-1
TYP. BASEMENT COLUMN &
PILE CAP ARRANGEMENT**
SCALE 1:20

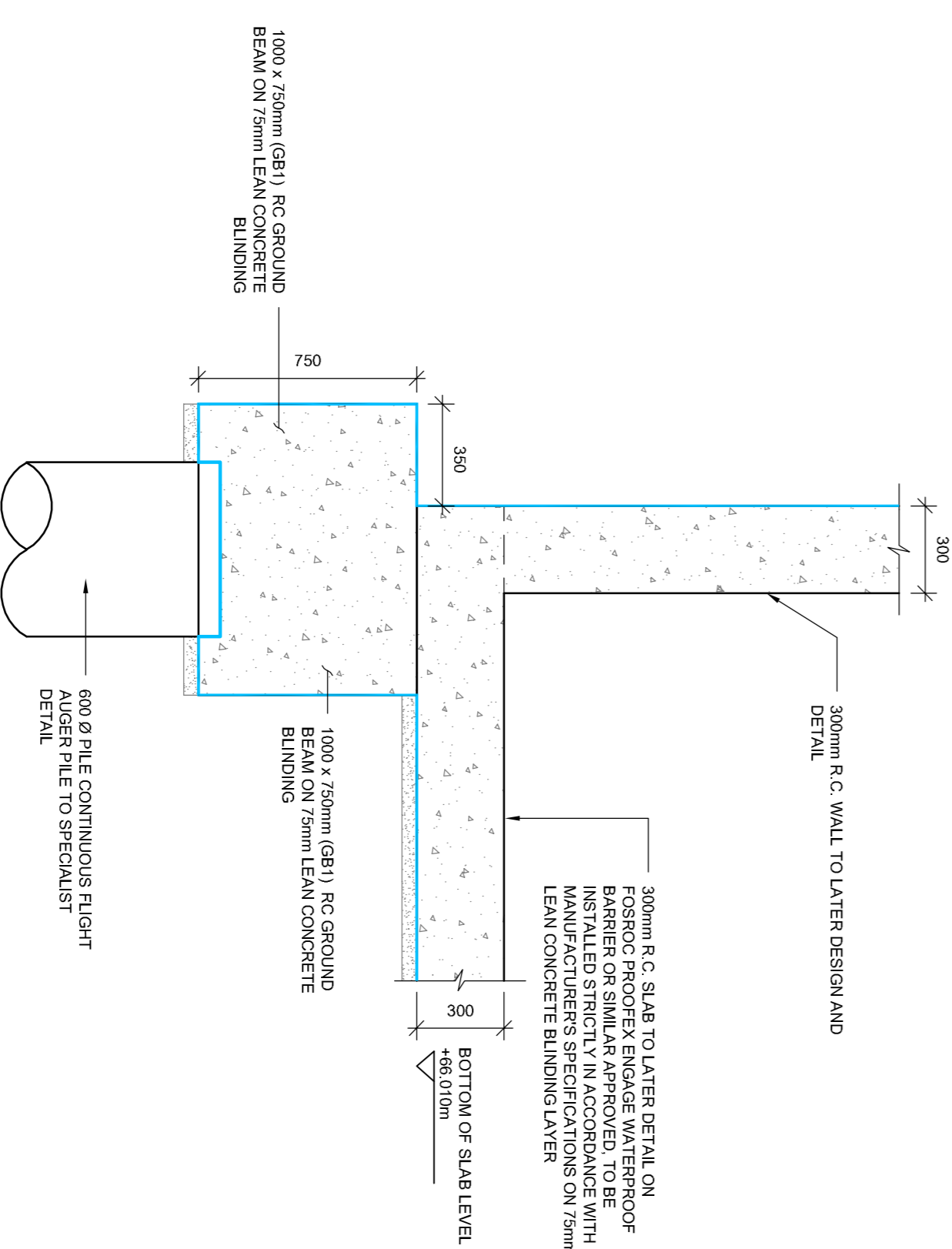

**SECTION 2-2
TYP. BASEMENT EXTERNAL WALL ON
GROUND BEAM ARRANGEMENT**
SCALE 1:20

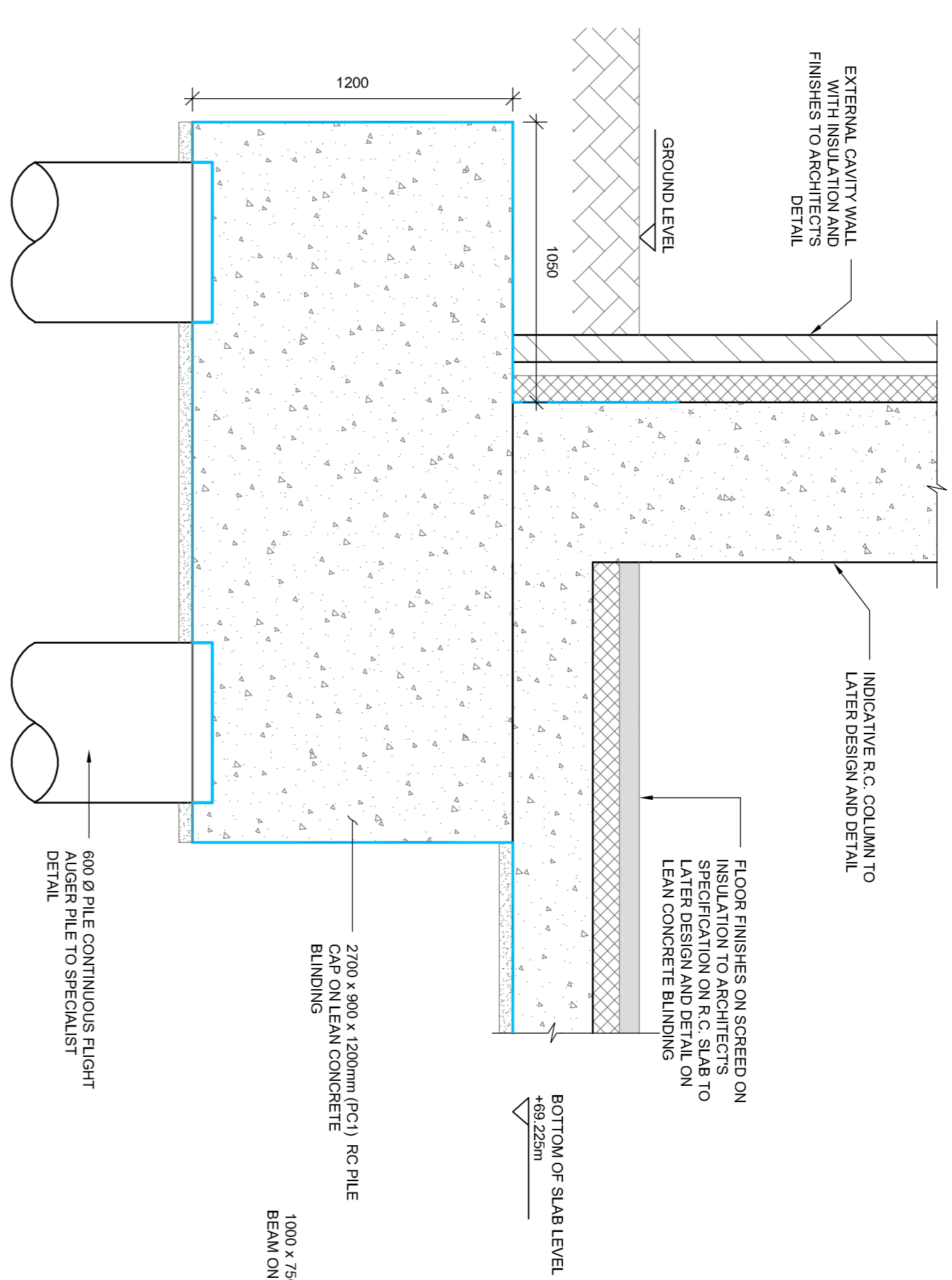

**SECTION 3-3
TYP. GF EXTERNAL COLUMN & PILE
CAP ARRANGEMENT**
SCALE 1:20

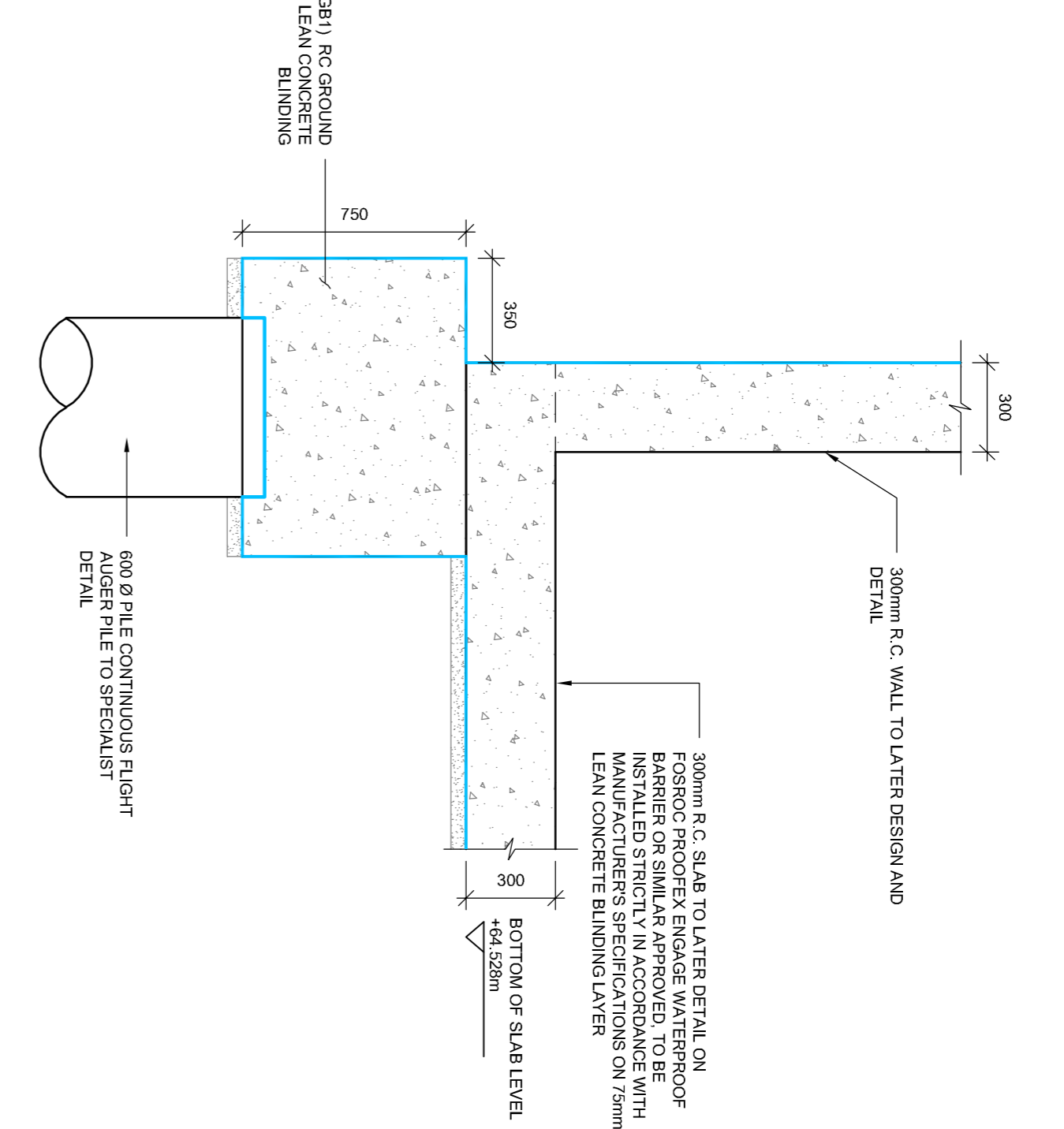

**SECTION 4-4
TYP. BASEMENT EXTERNAL WALL ON
GROUND BEAM ARRANGEMENT**
SCALE 1:20

- NOTES:**
- FORMATION LEVEL OF SLAB IS BASED ON THE ASSUMPTION THAT THICKNESS OF SOURED AND INSULATION IS 175mm. THIS WILL BE DEPENDENT ON BUILDING REGULATIONS AND MUST BE CHECKED AGAINST THE LOCAL BUILDING REGULATIONS. FOUNDATION LEVEL WILL BE REVISED ACCORDINGLY.
 - CONSTRUCTION SECTION DETAILS ARE SUBJECT TO CHANGE CALCULATING ALL DESIGNED DESIGN STAFF RESPONSIBILITY AND SIGNED TO A SUFFICIENT DEGREE OF PERMISSION.

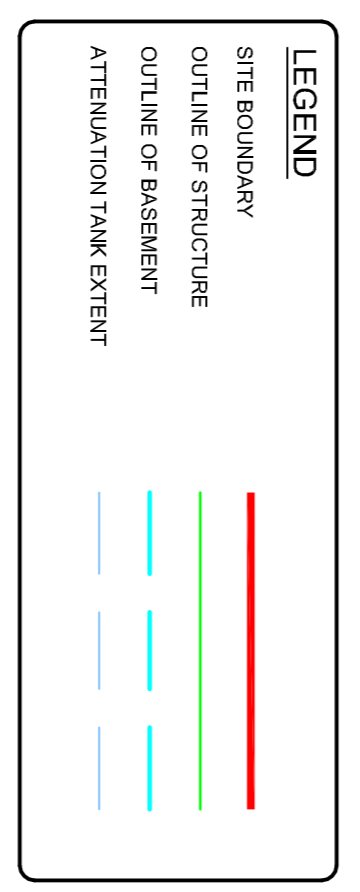

| Rev | Date | Dim | CHK'd | Description |
|-----|------------|------|-------|---------------------------------|
| P | 13/01/2022 | D.M. | G.P. | Issued for Stage 3 SHD Planning |
| | | | | |
| | | | | |
| | | | | |
| | | | | |

LOHAN & DONNELLY
Consulting Engineers

13 Gardiner Place, Mountjoy Square, Dublin 1. T: 01 8787770
www.lohan-donnelly.com E: info@lohan-donnelly.com

| | | | | | |
|----------|--|-------------|------|---------|----------|
| Project: | Mixed-Use Development at Jamesstown Road, Finglas, D11 | Project No: | 2038 | Doc No: | CO3 |
| Drawing: | Typical Foundation Sections | Scale: | @A1 | Date: | Jan 2022 |

| | | | |
|--------------------|--------------------------|-------------|-----|
| Model Reference: | 2038-LDE-ZZ-ZZ-M2-C-0002 | Model Rev.: | P01 |
| Drawing Reference: | 2038-LDE-ZZ-ZZ-DR-C-4003 | Stability: | S4 |