

# BLOCK B

- GENERAL NOTES**
1. COPYRIGHT RESERVED
  2. DO NOT SCALE DRAWING. USE FIGURED DIMENSIONS ONLY.
  3. ALL DISCREPANCIES TO BE REPORTED TO ARCHITECT.
  4. THE CONTRACTOR IS RESPONSIBLE FOR CHECKING ALL LEVELS AND DIMENSIONS.
  5. ALL STRUCTURE TO BE TO STRUCTURAL ENGINEERS DETAILS.
  6. ALL MECH/ELEC SERVICES TO SERVICES ENGINEERS DETAILS.
  7. ALL PROPRIETARY ITEMS TO BE INSTALLED IN ACCORDANCE WITH MANUFACTURERS INSTRUCTIONS.
  8. CONTRACTOR IS RESPONSIBLE FOR THE COORDINATION OF STRUCTURE FINISHES AND SERVICES.

REV	DATE	DESCRIPTION	BY

\*For all internal dimensions of apartment units, please refer to the JFA Housing Quality Assessment included with this submission

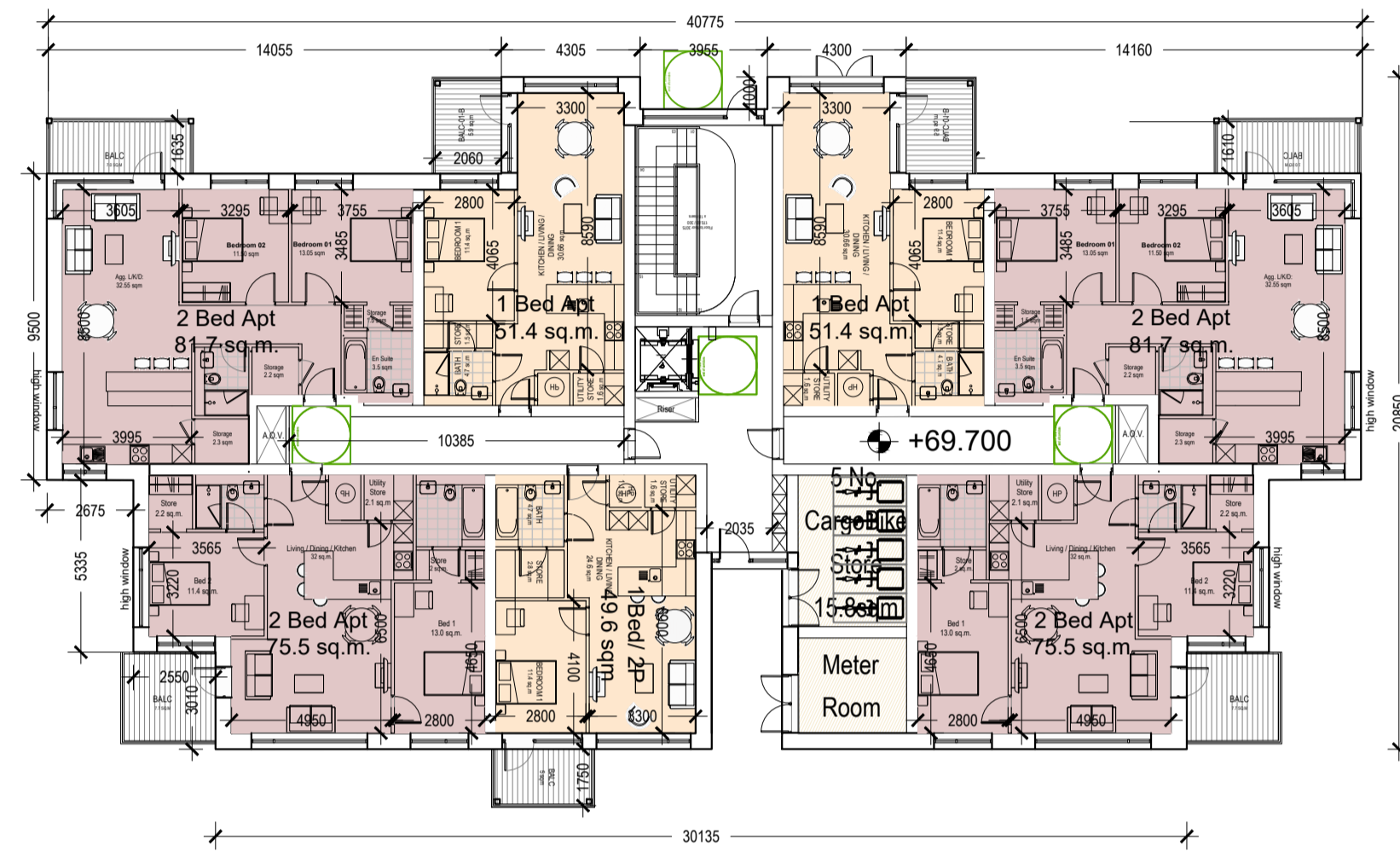

Ground Floor Plan 1:200 @ A1

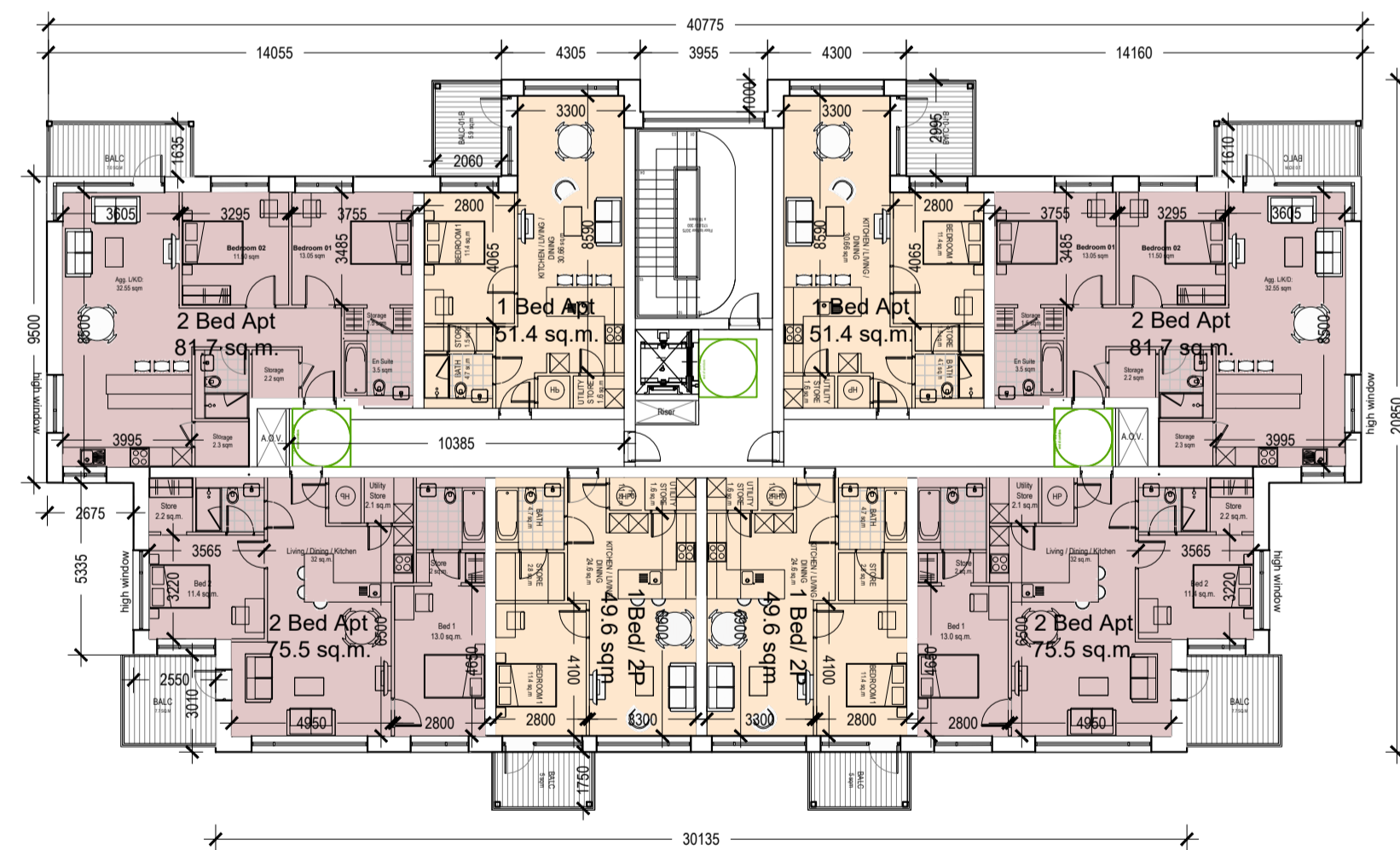

First - Fifth Floor Plan 1:200 @ A1

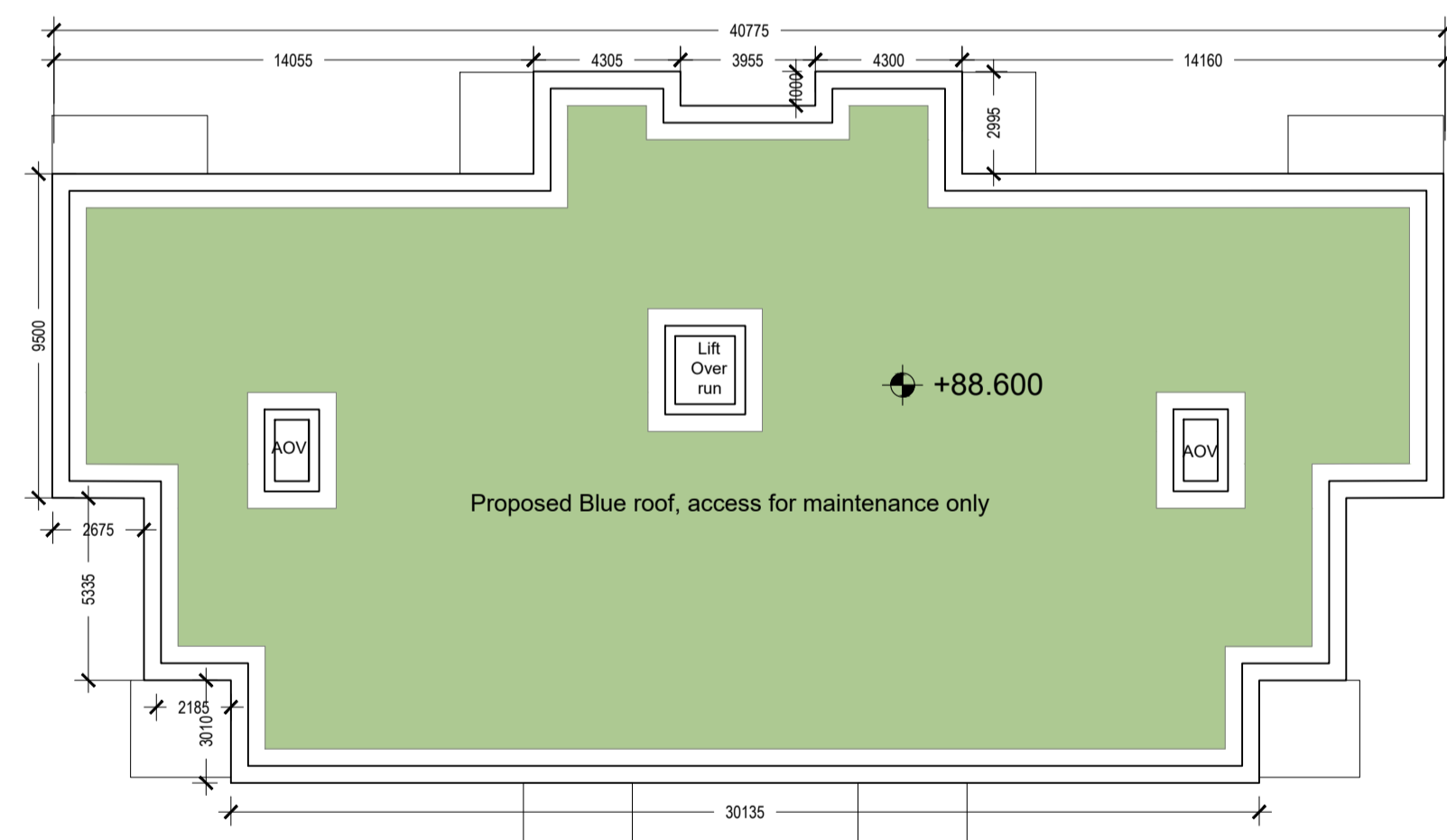

Roof Plan 1:200 @ A1

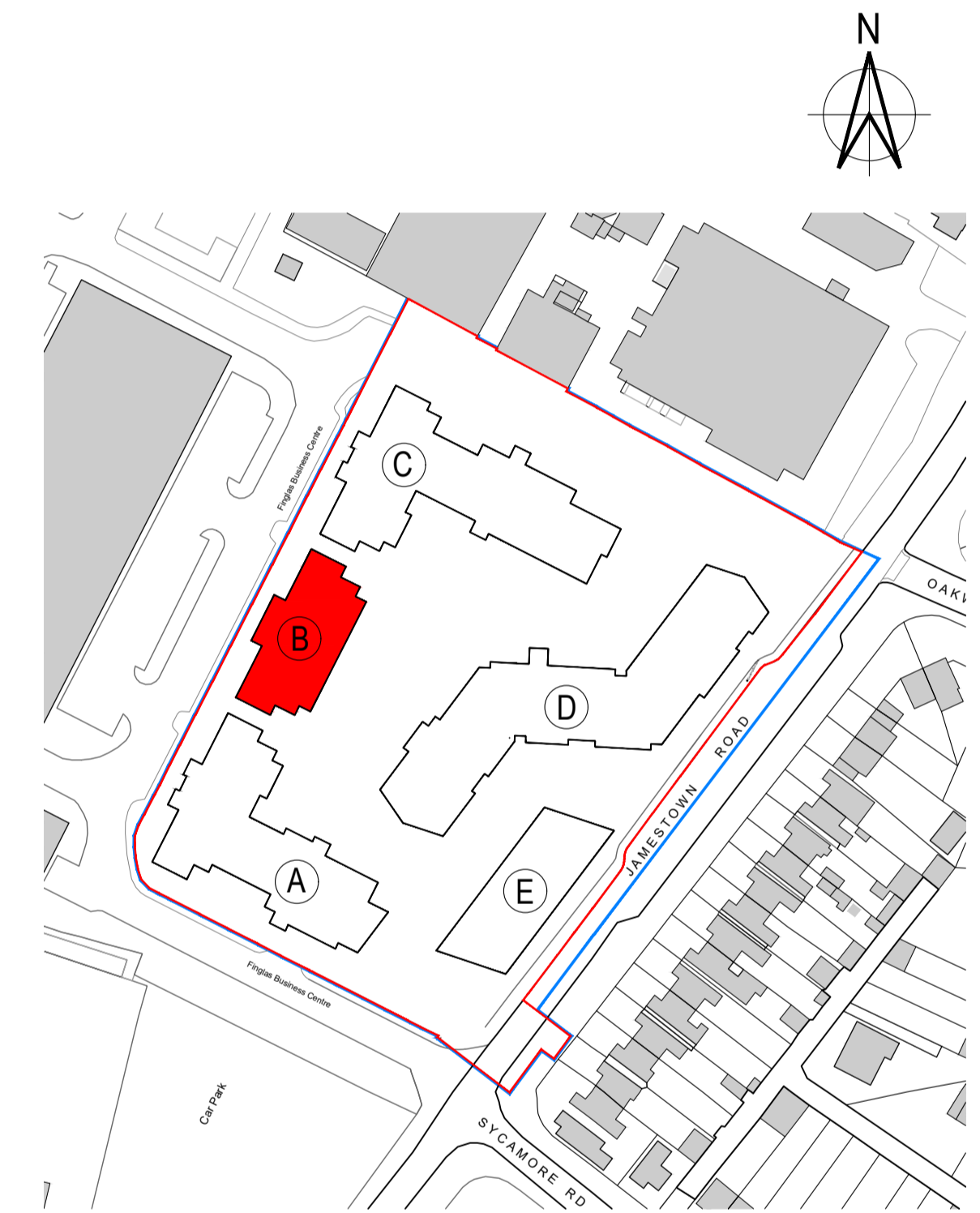

KEY PLAN

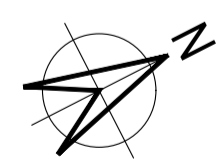

Level	Block B
First	+72.850
Second	+76.000
Third	+79.150
Fourth	+82.300
Fifth	+85.450



**JOHN FLEMING ARCHITECTS**

THE TREE HOUSE, 17 RICHVIEW OFFICE PARK, CLONSKEAGH, D14 XR82, IRELAND  
T: (01) 6689888 E: info@jfa.ie W: www.jfa.ie

CLIENT  
Jamesstown Village Limited

PROJECT  
Jamesstown Road SHD  
Mixed Use Development, Fingis, Dublin 11

DRAWING  
Block B  
Plans

SCALE 1:200 @ A1 JOB NO. 1873  
DRAWN BY RM  
DATE JANUARY 2022  
DRAWING NUMBER JTR-ZZ-BB-DR-JFA-A-P2001 REVISION -

DRAWING LOCATION  
\*1873\_jfa\_1873-00-current.dwg

DRAWING STATUS  
SHD PLANNING APPLICATION

